

NOTES: (UNLESS OTHERWISE SPECIFIED)

REVISIONS						
ZONE	REV.	DESCRIPTION	DATE	BY	ECO	APRV
	A	UPDATED TO NEW DRAFTING STANDARD	10/14/2004	JAG	2680	
	B	Add 'R' to part Number	9/19/2005	GH	2859	GH

FAI Required

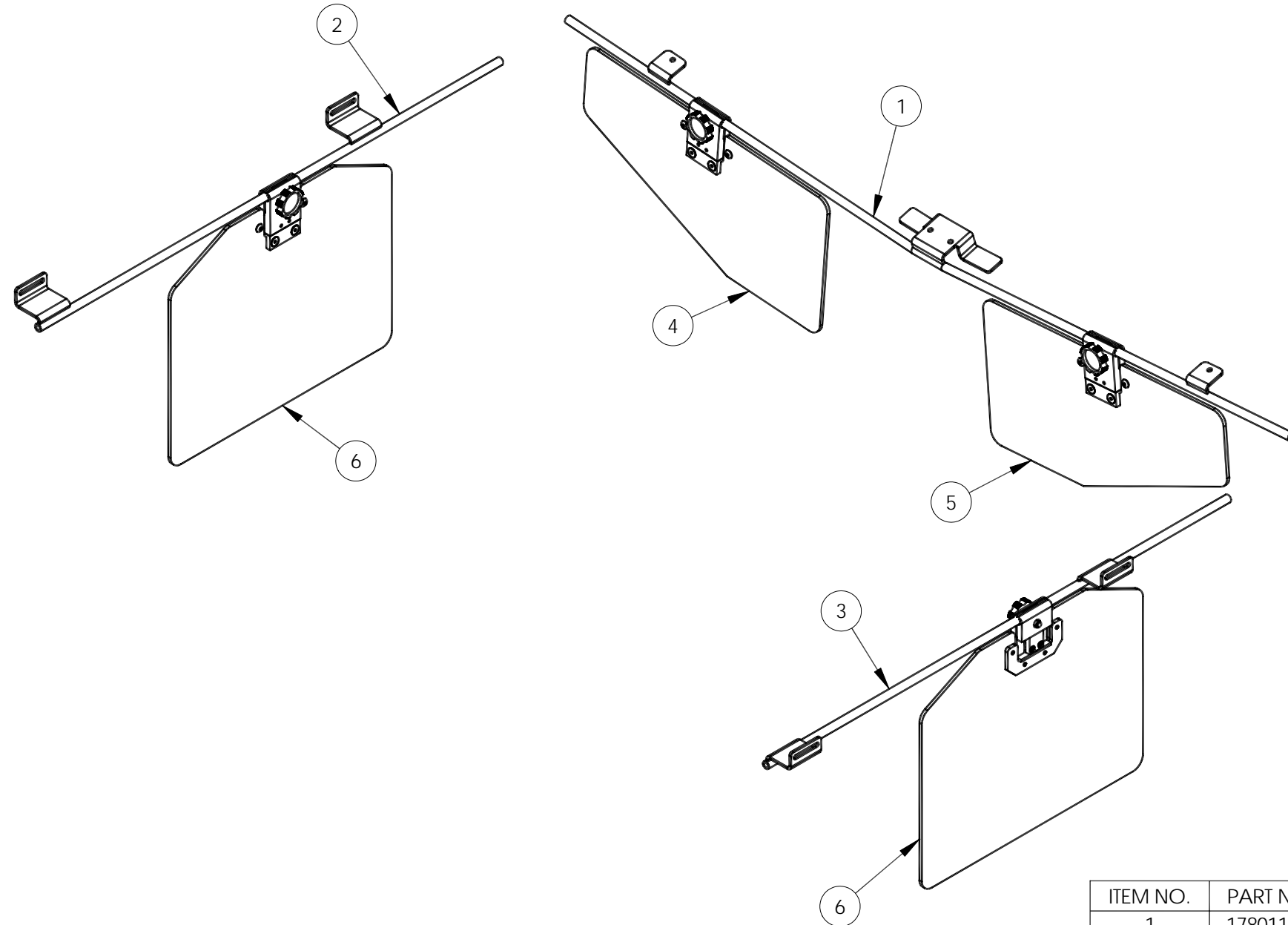

REFERENCE: RG-I/II-300-1 COMPLETE ASSEMBLY

ITEM NO.	PART NUMBER	REFERENCE	DESCRIPTION	QTY.
1	1780110	RG-I/II-100-3 FORWARD RAIL ASSY	FORWARD MONORAIL ASSEMBLY	1
2	1780111-1	RG-I/II-100-1 PILOT	SIDE MONORAIL ASSEMBLY-PILOT	1
3	1780111-2	RG-I/II-100-2 COPILOT	SIDE MONORAIL ASSEMBLY-COPILOT	1
4	R1780400-1	RG-I/II-300-5-1	FRONT VISOR ASSEMBLY-PILOT	1
5	R1780400-2	RG-I/II-300-5-1	FRONT VISOR ASSEMBLY-COPILOT	1
6	R1780500	RG-I/II-300-3-1	VISOR ASSEMBLY	2

UNLESS OTHERWISE SPECIFIED:
 DIMENSIONS ARE IN INCHES
 TOLERANCES:
 .XX = ± 0.015
 .XXX = ± 0.005
 ∠ = ± .5°
 SURFACE = 64

INTERPRET DIM AND TOL
 PER: ASME Y14.5M - 1994

MATERIAL:
 NA

	NAME	DATE
DRAWN	JAG	10/14/04
CHECKED	AW	11/01/04
ENG APPR.	GH	11/01/04
MFG APPR.	PB	11/04/04
MATERIALS	MAE	11/05/04

Rosen SUNVISOR SYSTEMS
 ROSEN SUNVISOR SYSTEMS LLC
 86365 COLLEGE VIEW ROAD
 EUGENE, OREGON 97405
 TEL: (541) 747 0034

TITLE:
COMPLETE MONORAIL SYSTEM

PROPRIETARY AND CONFIDENTIAL
 THE INFORMATION CONTAINED HEREIN IS PROPRIETARY TO ROSEN SUNVOR SYSTEMS LLC. ANY REPRODUCTION IN PART OR AS A WHOLE WITHOUT THE WRITTEN PERMISSION OF ROSEN SUNVOR SYSTEMS LLC IS PROHIBITED.

TOP LEVEL	GS I/II
NEXT ASSY	USED ON
APPLICATION	

CoM: N/A

DO NOT SCALE DRAWING

WEIGHT: 4.237 LBF

SIZE	DWG. NO.	REV
B	R1780000	B
ASSY	SCALE: 1:5	SHEET 1 OF 1